



10" Cradle Feeder

C
R
A
D
D
L
E
F
E
E
D
E
R

LARGE VOLUME FEEDING OF SILAGE, HAYLAGE, MIXED FEEDS

The *Silo-Matic Cradle Feeder* is designed to handle large volume feeding. Heavy duty 9 inch augers handle enough feed, whether it's bulk forage, grain or mixed feeds, for your entire herd. Integral design of auger, expansion chamber and conveyor provides more uniform mixing and feeding throughout the entire length of the bunk. The auger "floats" in the expansion chamber and has no bearings to impede feed flow. **There's no clogging, jamming or freezing!** Rugged steel construction resists hard use and the roughest weather conditions. Designed and engineered for applications of up to 100' with low R.P.M. for smooth quiet operation and less vibration.

FEATURES

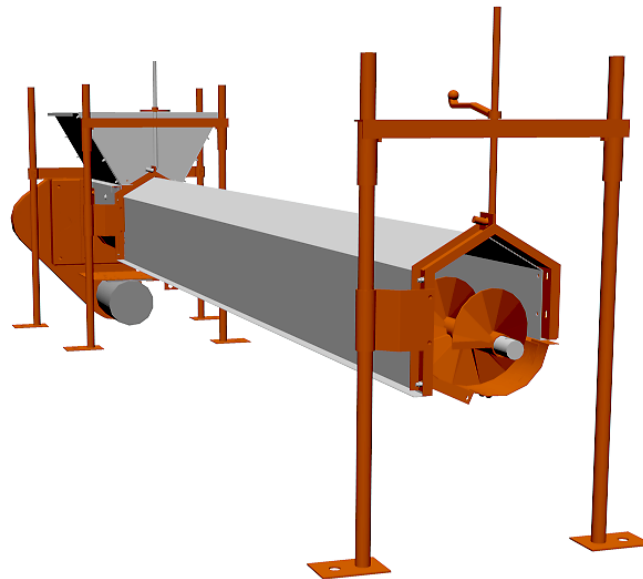

- Adjustable for grain or forage
- Design Eliminates Binding, Clogging
- Moving Parts Enclosed-Weather Protected
- Adaptable to most any type of bunk
- Low Horsepower requirements

The big 9" heavy duty auger operating within a large expansion chamber moves even the most bulky forages easily and quickly the full length of the bunk. You feed your entire herd in just a matter of minutes. Every detail of construction is engineered for long, trouble free life. Top-grade steel construction resists the hardest use and the toughest weather. The highly adaptable design allows it to fit perfectly into most any type of bunk.

ADDITIONAL FEATURES

HOW IT WORKS:

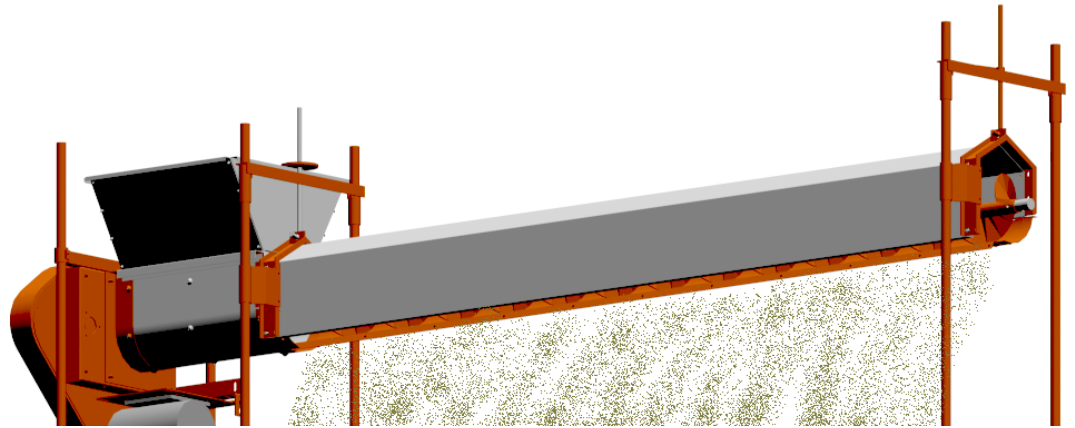

Feed is conveyed by the augers riding on the cradle plates and falls out of the opening progressively into the bunk.

The CRADLE FEEDER provides a versatile feeding system, equally efficient when feeding roughage, mixed feeds, or grain. The entire feeder is raised or lowered with adjustment handles at the top of the support frames. You merely select the height best suited for the type of rations being fed to your livestock.

OPTIONS

- 5' Baffle plates are available for sealing the bottom section of the feeder for areas in which no feed delivery is desired.
- Optional U-trough starter sections can be used in place of the standard 2' section used on the feed hopper. Available in 5 & 10' Lengths.

SPECIFICATIONS

AUGER DIAMETER	9"
AUGER FLIGHTING THICKNESS	10 GAUGE
CRADLE PAN THICKNESS	14 GAUGE
MAXIMUM FEEDER LENGTH	100'
MOTOR REQUIREMENTS	
For 40' through 55'	1-1/2 HP
For 60' through 85'	2 HP
For 90' through 100'	3 HP
DRIVE SPECIFICATIONS	V-BELT & #50 ROLLER CHAIN REDUCTION

Silo-Matic and Valesco Manufacturing, Inc. reserve the right to change features and specifications due to research and development being applied at the time of this printing. Photos may show doors, guards and shields open or removed for illustration purposes only. Be sure that all doors, guards and shields are in their proper operating positions before starting equipment.

Your Authorized Silo-Matic Dealer:

**Still Built to Handle
the Daily Grind.**



VALESKO MFG. INC.
7857 N 1100 E
LOOGOOTE, IN 47553

(812) 636-6001
www.silo-matic.com

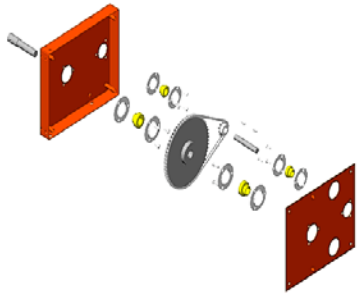

▪ BELT/CHAIN REDUCTION DRIVE

Designed and engineered with low rpm for smooth, quiet operation and less vibration. The drive motor can be mounted on either side or under the feeder. Drive components are assembled from standard parts.

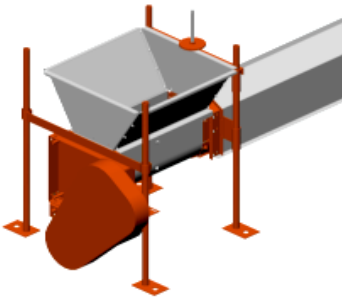

▪ HOPPER & STARTER SECTION

Allows any length of U-trough conveyor to be used before discharging feed into bunk. The special design of the conveyor chamber, trough and auger results in excellent mixing action and the feed is more uniform the full length of the feeder.

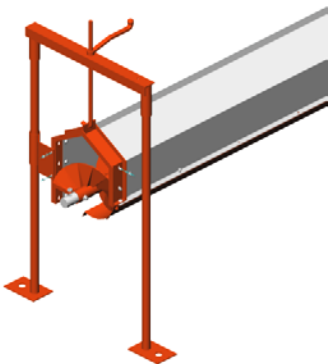

▪ FEEDER SECTIONS

Feeder Sections are available in 10' and 5' Lengths to allow flexibility in feedlot designs up to 100 feet long.